

SUCÇÃO: 1.1/2" BSP      RECALQUE: 1" BSP



Tabela de Medidas

Modelo	CV	L	B	BB	HD
TH-16 P Trif.	1/2	292	76,2	---	---
TH-16 P Monof.	3/4	305			210
TH-16 P Trif.		302			---
TH-16 P Monof.	1,0	315			210
TH-16 P Trif.		322			---
TH-16 P Monof.	1,5	325			210
TH-16 P Trif.		342		127	---
TH-16 P Monof.	2,0	335			210
TH-16 P Trif.		352			---
TH-16 P Monof.	3,0	355			210
TH-16 P Trif.		372			---

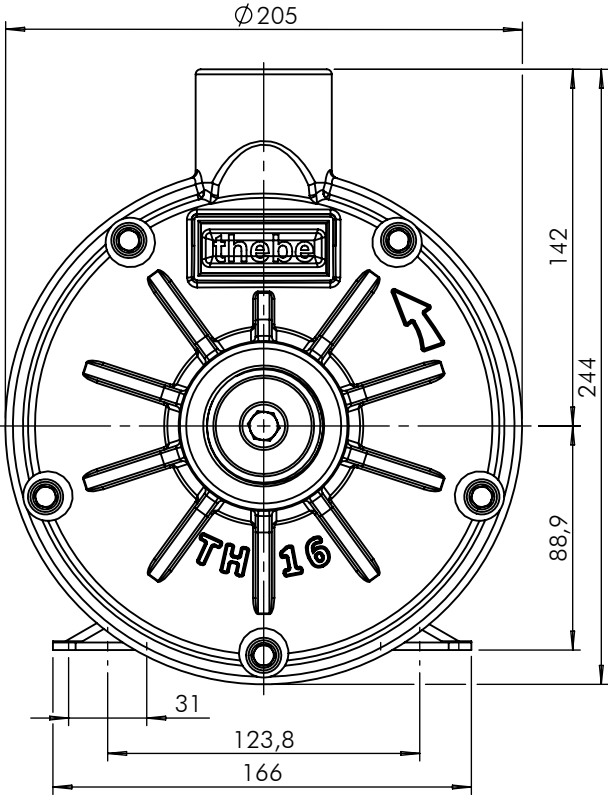
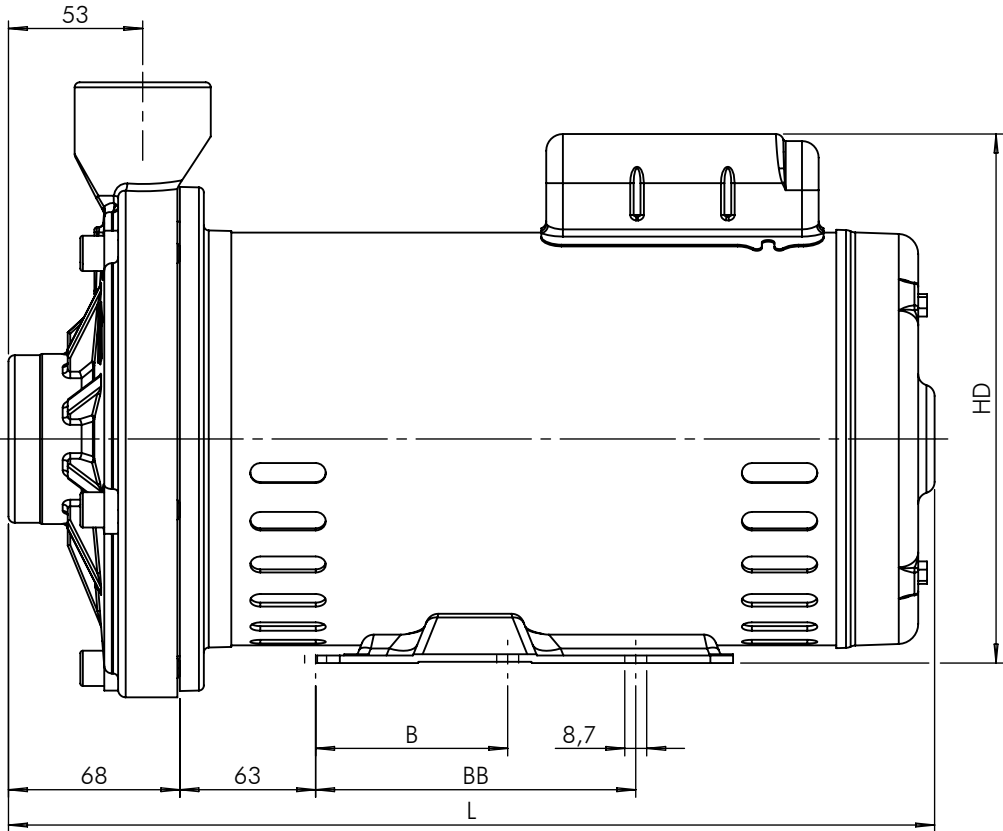

EXECUTADO	Ivo Gilberto	03/09/15
VERIFICADO	A.P.Scarpel	09/10/15
APROVADO	A.P.Scarpel	09/10/15
	NOME	DATA CRIAÇÃO

00	---	---	03/05/21	Gustavo G.	
REVISÃO	LOCAL	Nº DOCUM.	DATA	APROVADO	

Bomba TH-16 P Flange Incorporado

DESENHO Nº  
100162

